





KEYSTONES
FUNDAMENTOS
POINTS CLES

10

AESTHETICS
ESTETICA
BEAUTE

48

PROPOSALS
COMPLEMENTOS
IDEEES

78

MULTIPURPOSE
VERSATILIDAD
POLIVALENCE

116

PRINCIPLES

What really matters





Alignment

alignment

AL
IG
NM
ENT

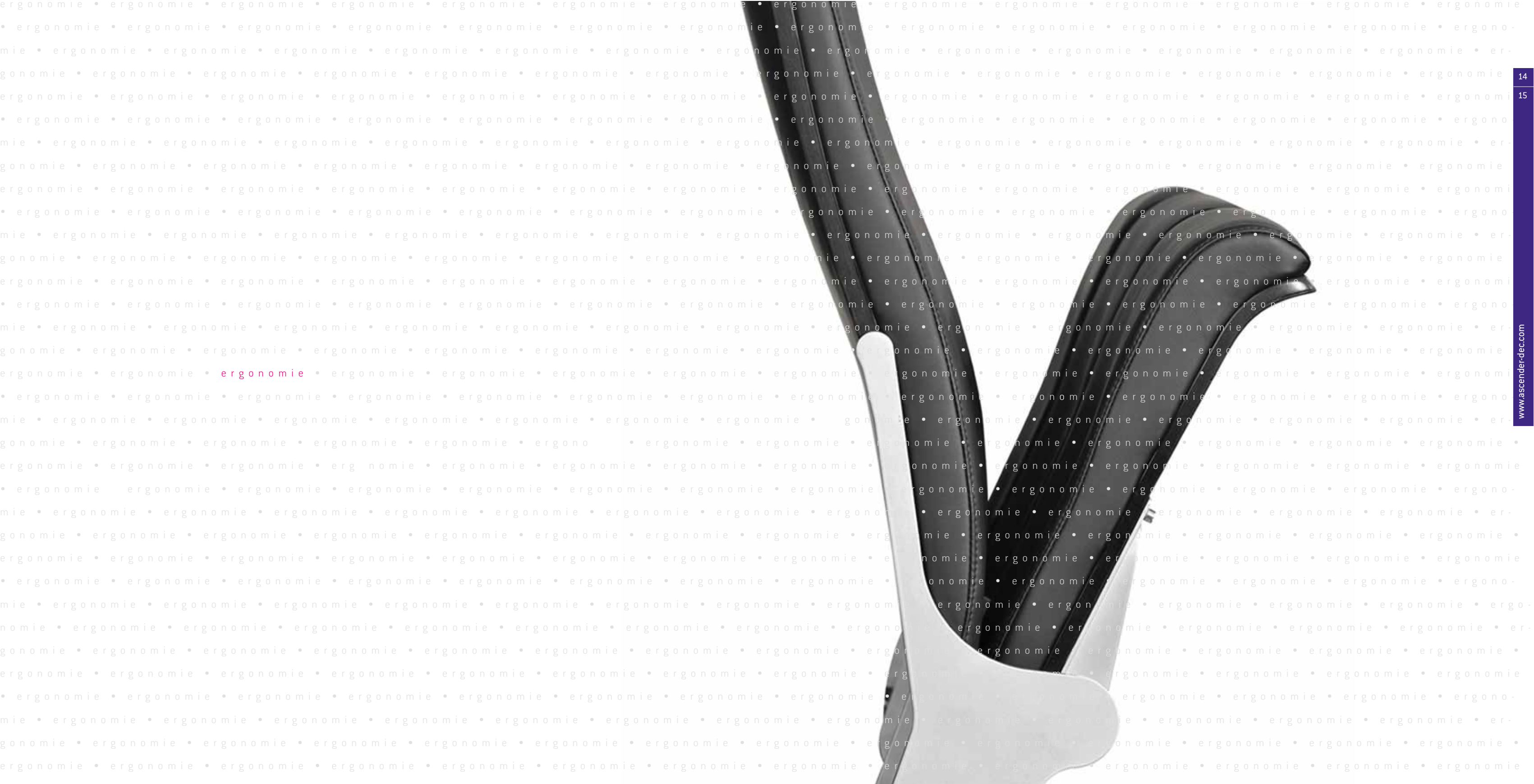



SA
FE
TY

Safety evacuation: **SEATWAY**

Normativa de seguridad: **EVACUACIÓN**

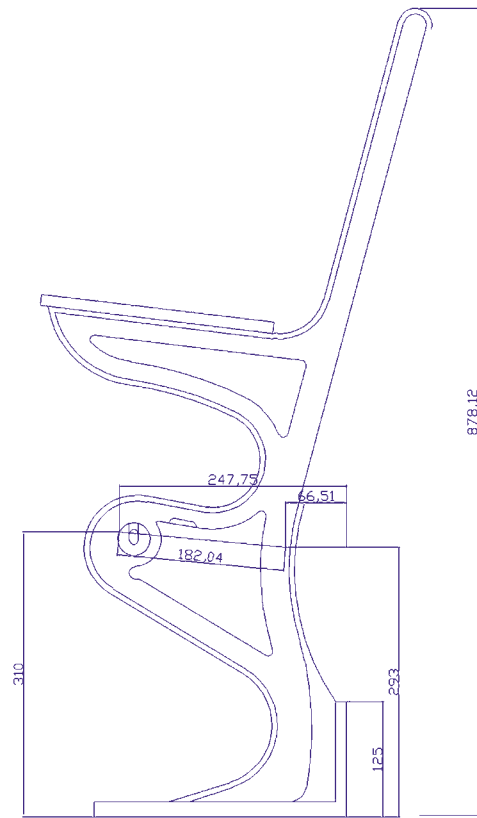



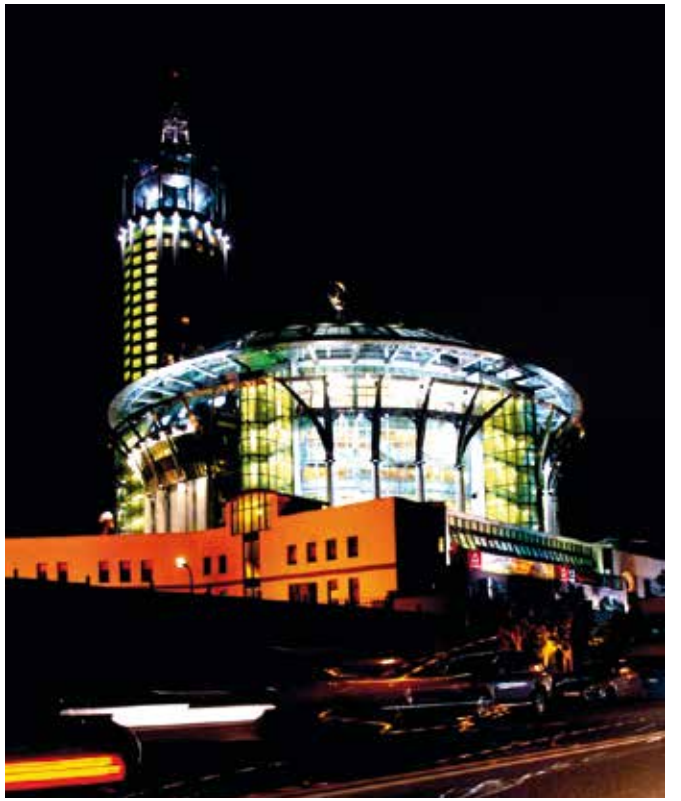



Slope / Pendenza / Pente

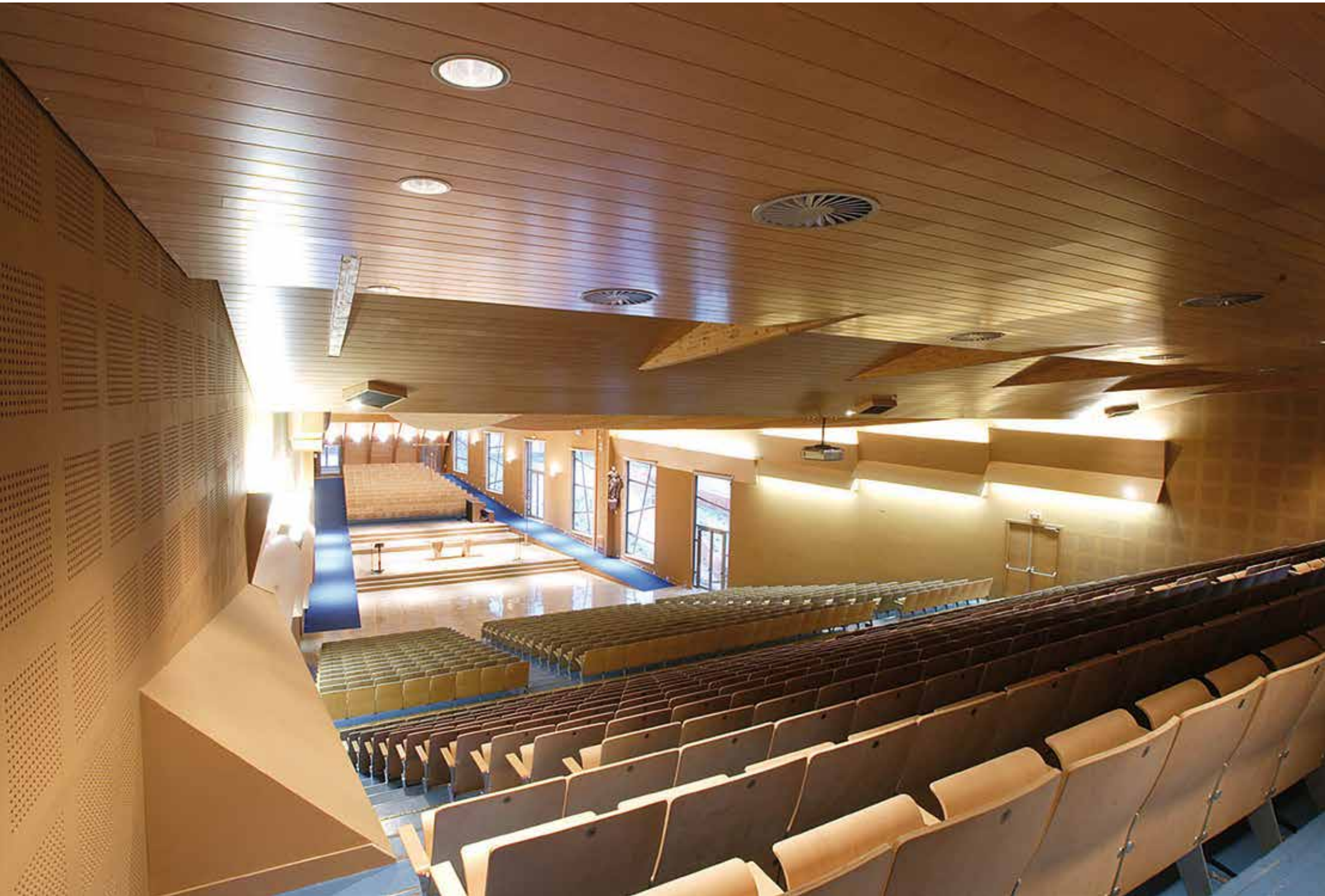

Isóptica

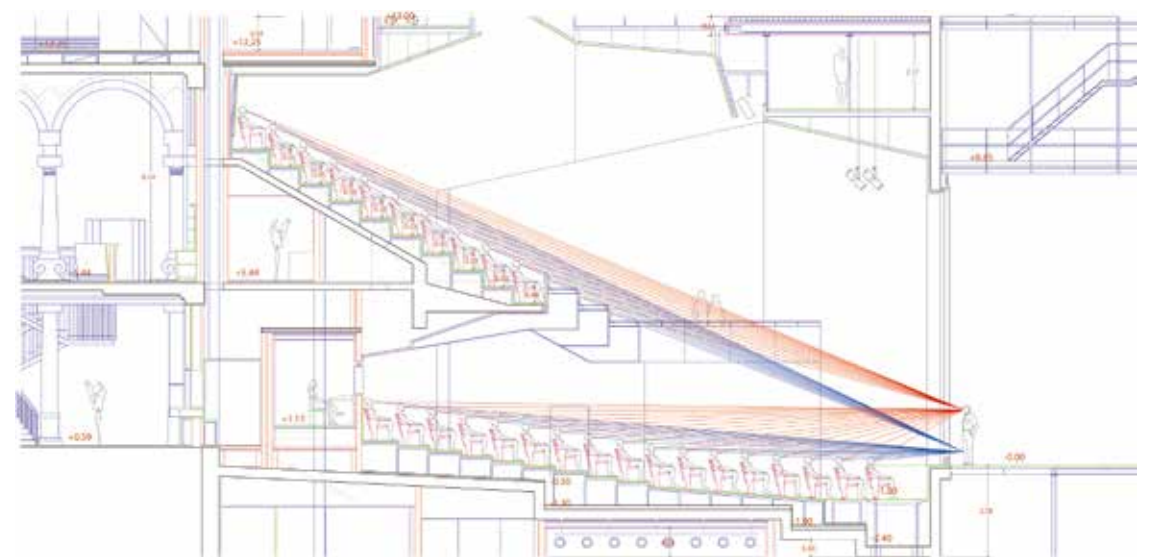

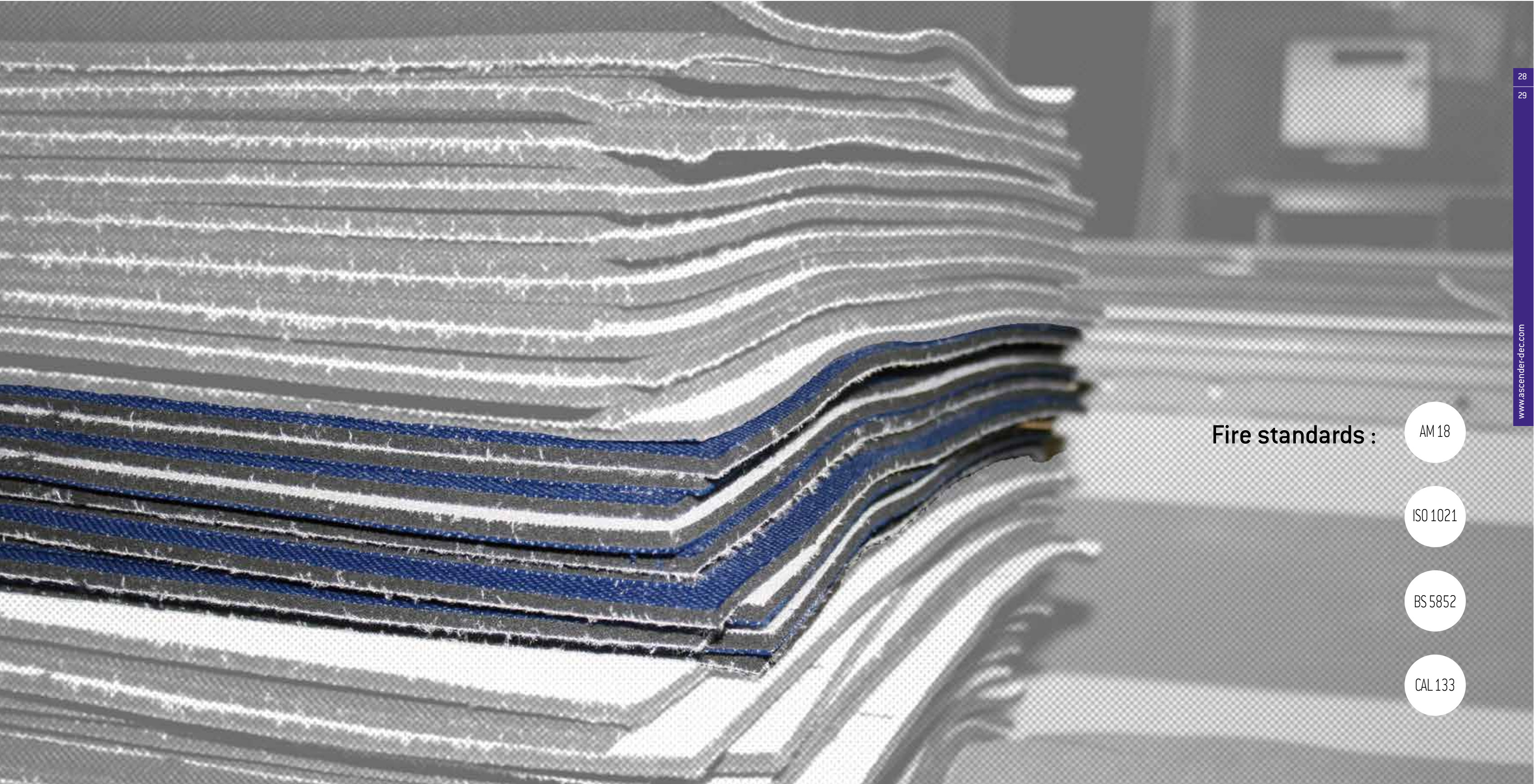

Fire standards :

AM 18

ISO 1021

BS 5852

CAL 133

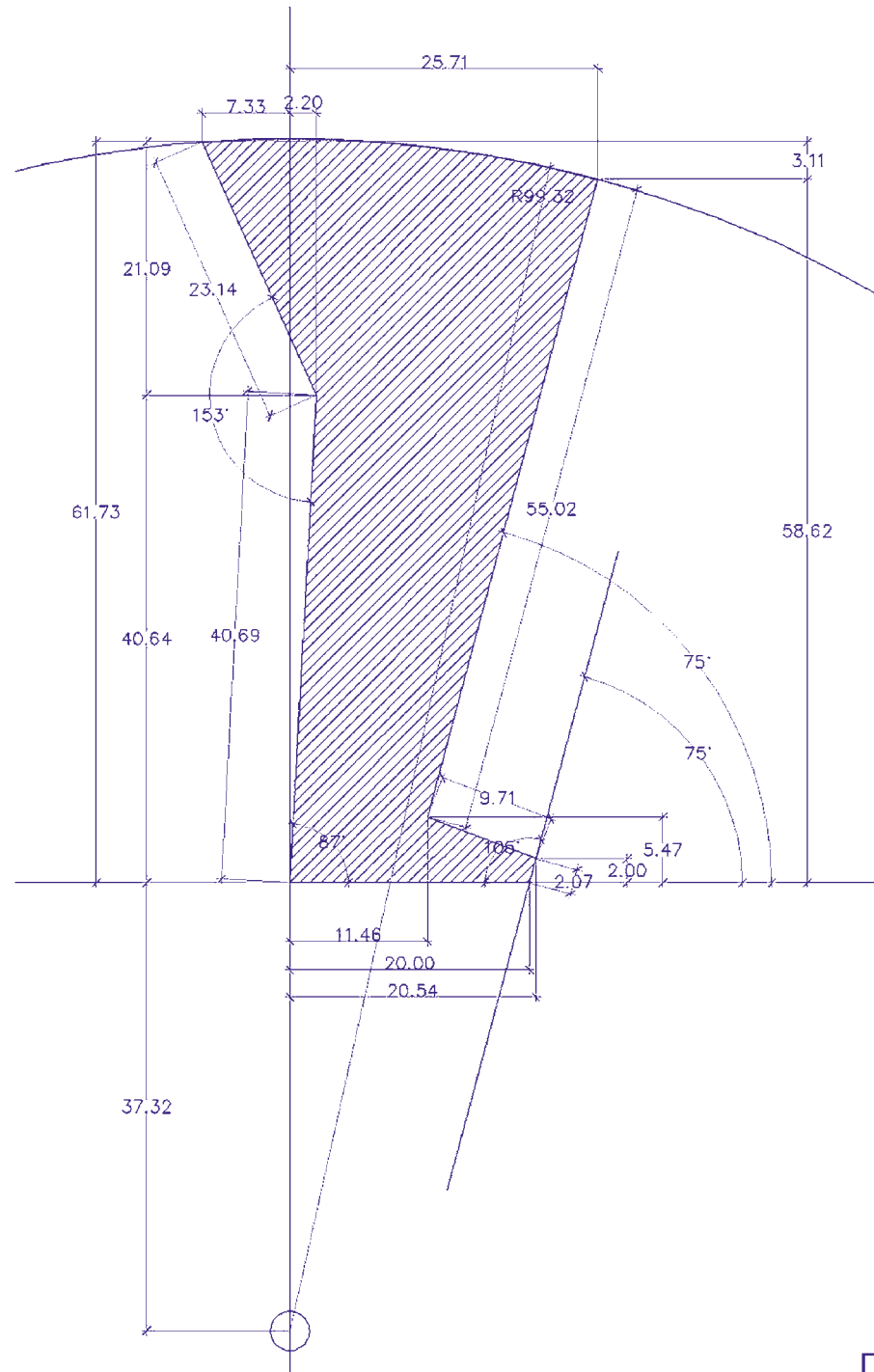

Dimensions

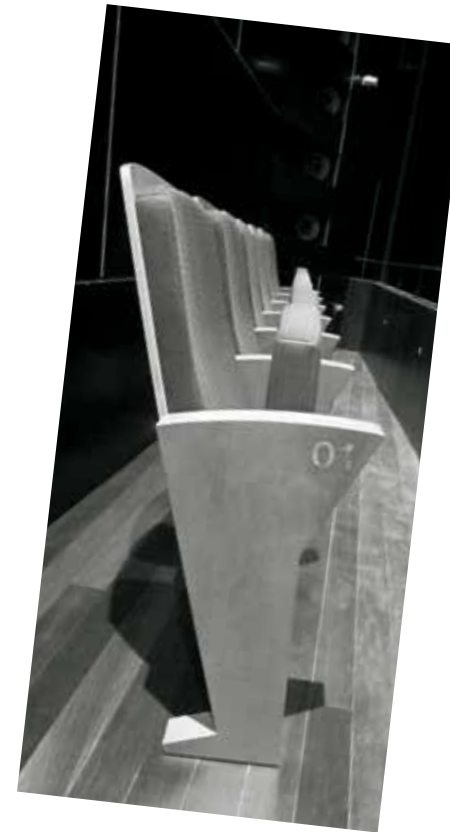
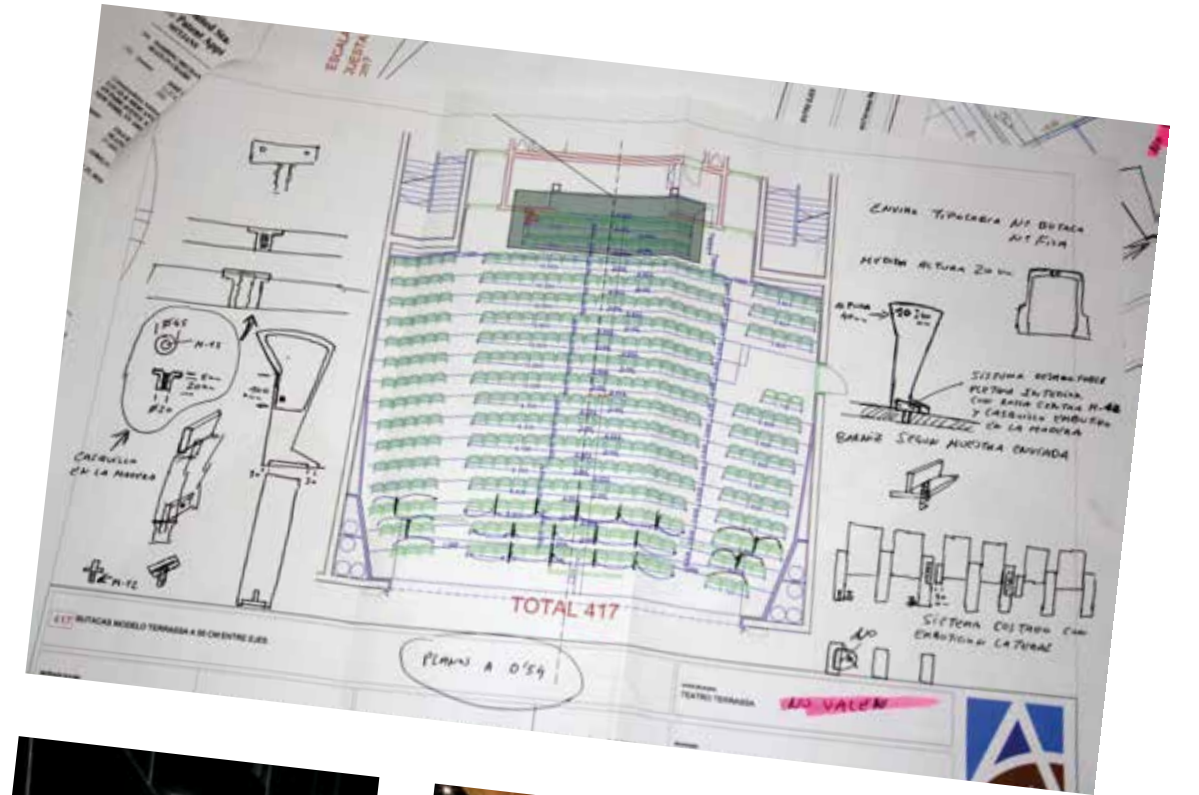

Same **sizes** for men and women?



¿Deberian ser iguales las butacas para niños y adultos?

Dimensions: pourquoi identiques dans les différents pays?



Aforo
Capacity

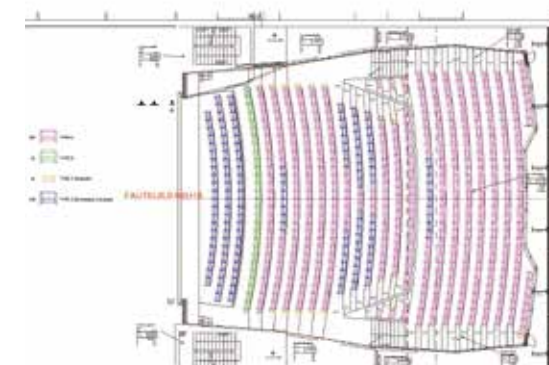
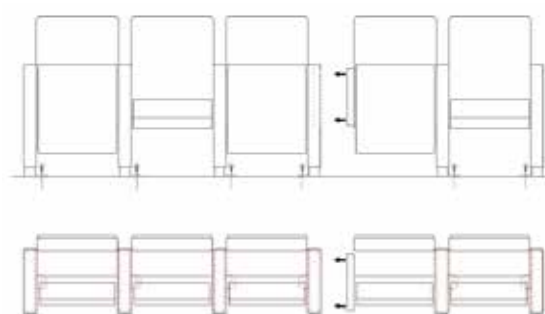

Acoustics: absorption versus reberverance

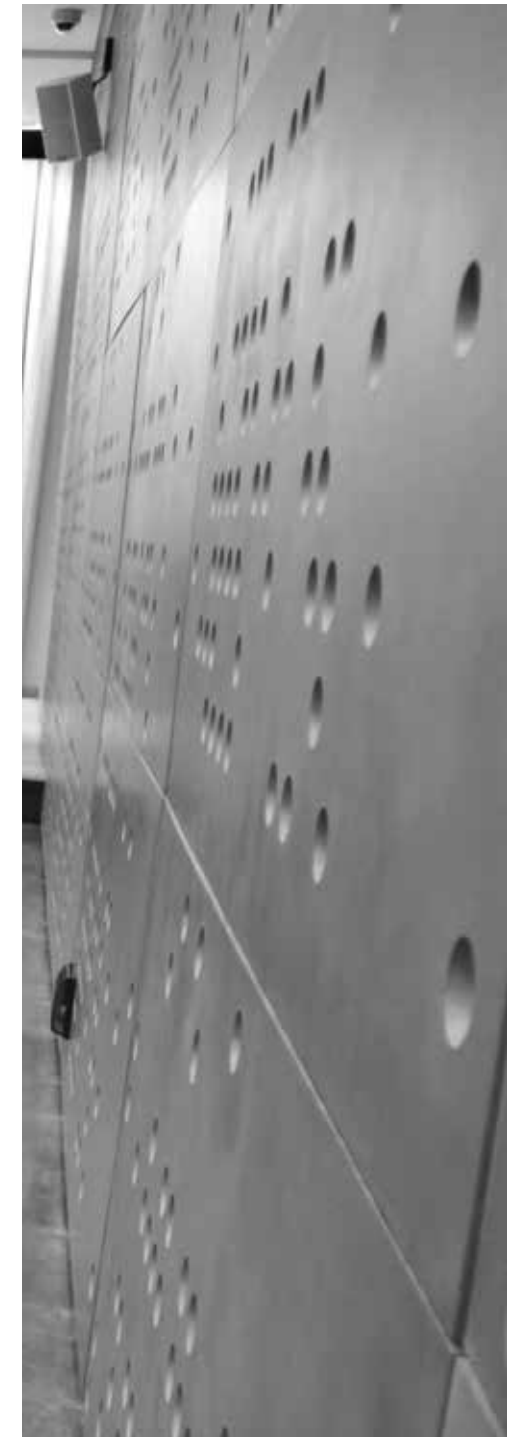
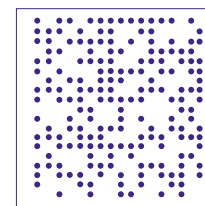



Disabled / ADA
PMR
Minusvalidos





Environment

Responsabilité sociale

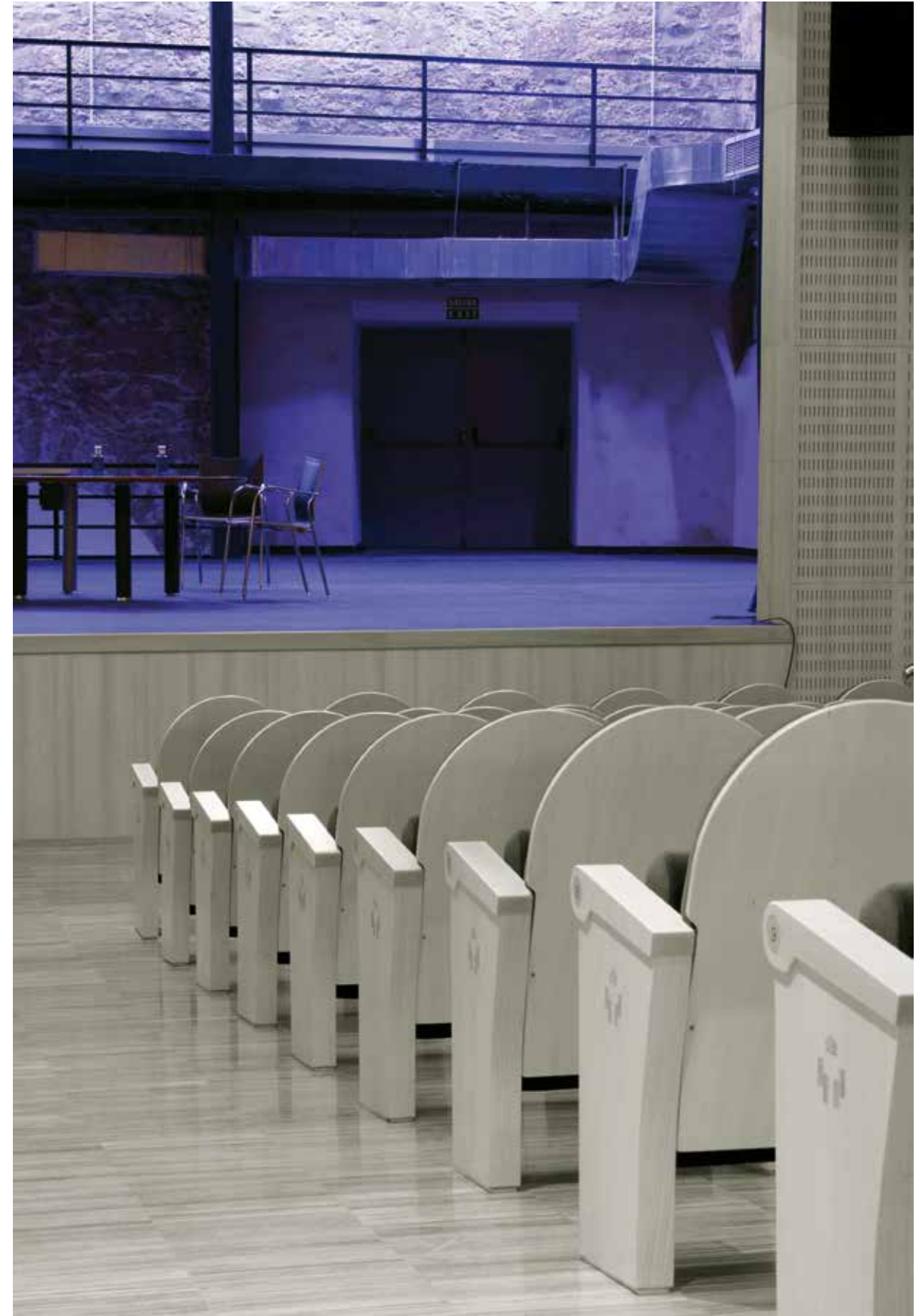



Compromise
with culture and sports





BEAUTÉ

Le recherche permanente



Full grain leather





Handicraft Stitching





Colors





Motives





The beauty of natural wood



Aluminium





Espíritu minimalista

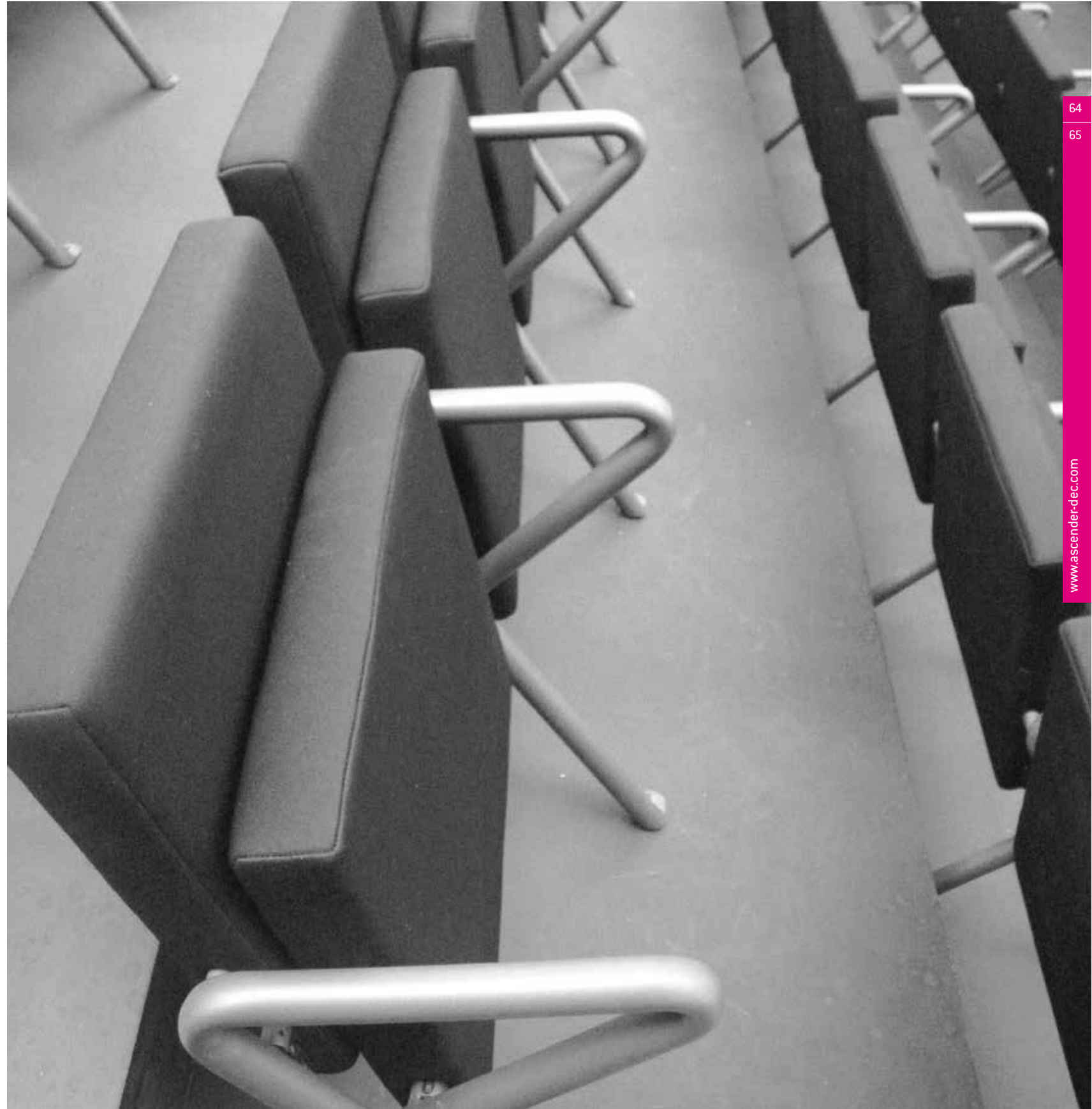

Volume





Straight lines

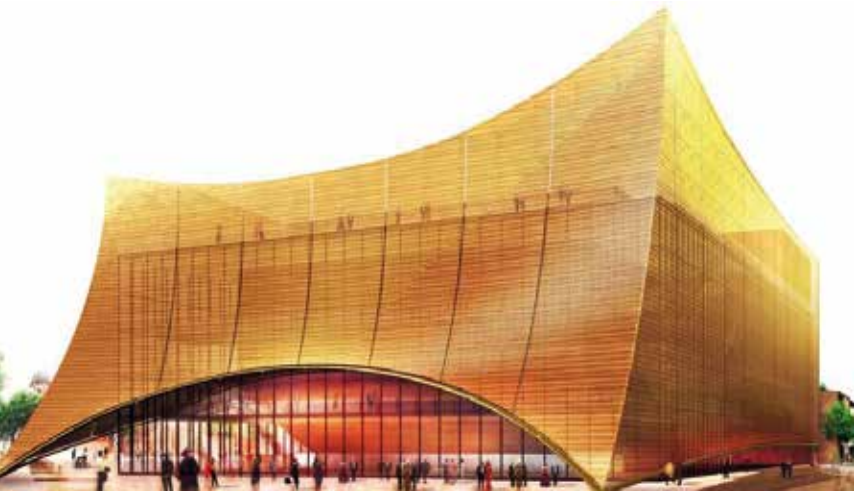
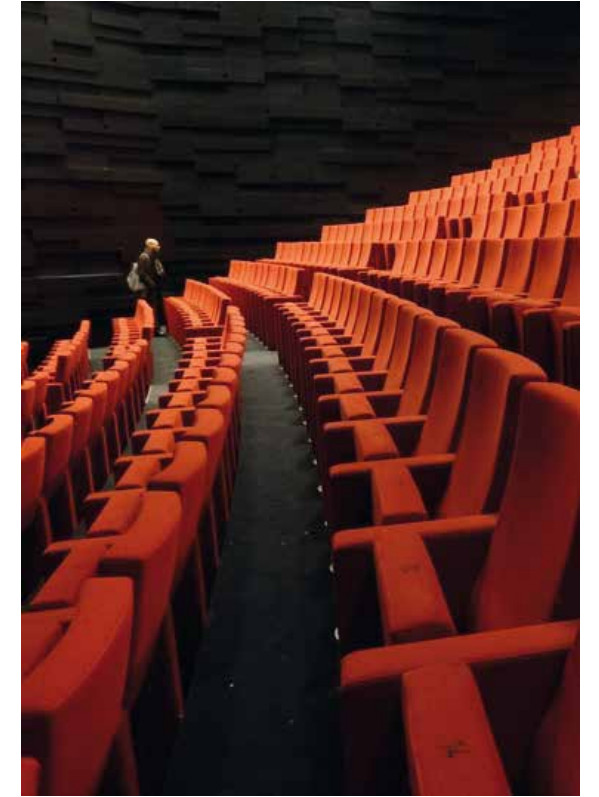

Sobriety

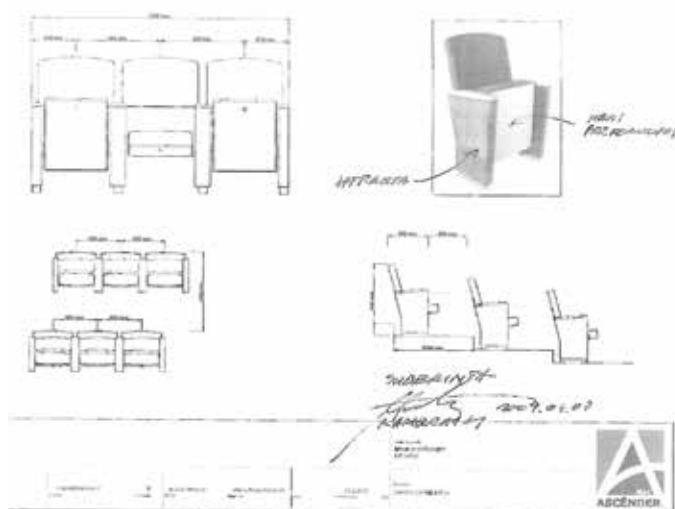



Geometry

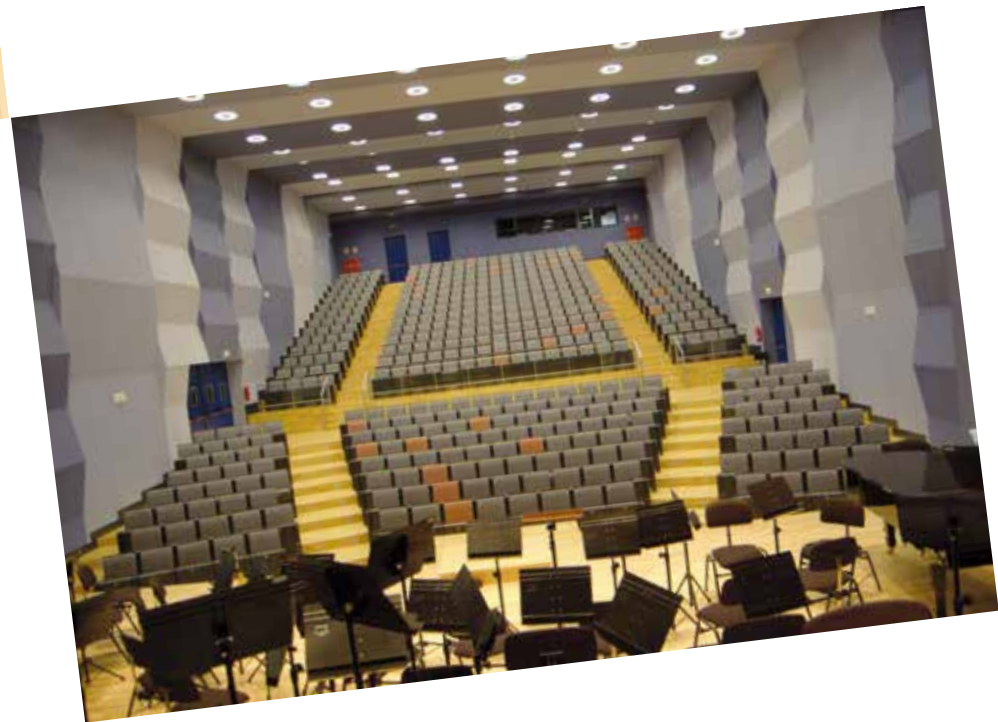

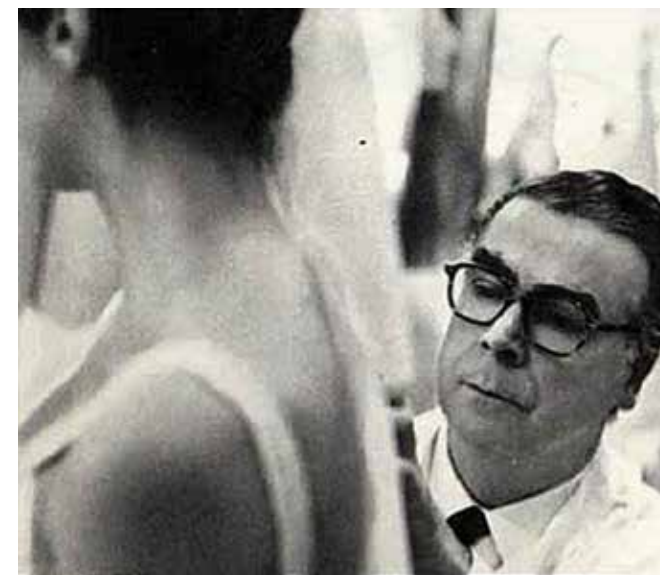

And the inspiration of a genius

IDEES

El consenso entre las partes



IMDEA , diseño y equipos de conferencia de la mano del estudio LAMELA



DETALLE BUTACA CON TOMA ELÉCTRICA Y BANDEJA EXTRAÍBLE, E:1/30



SECCIÓN 1

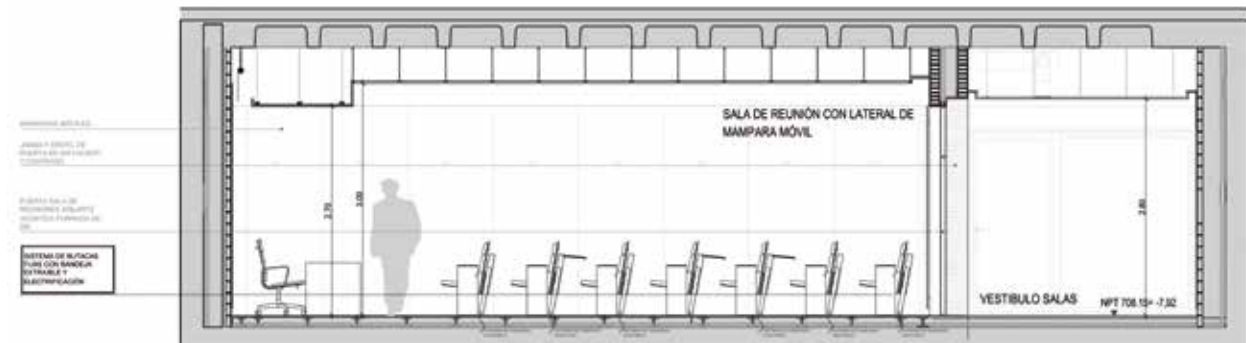





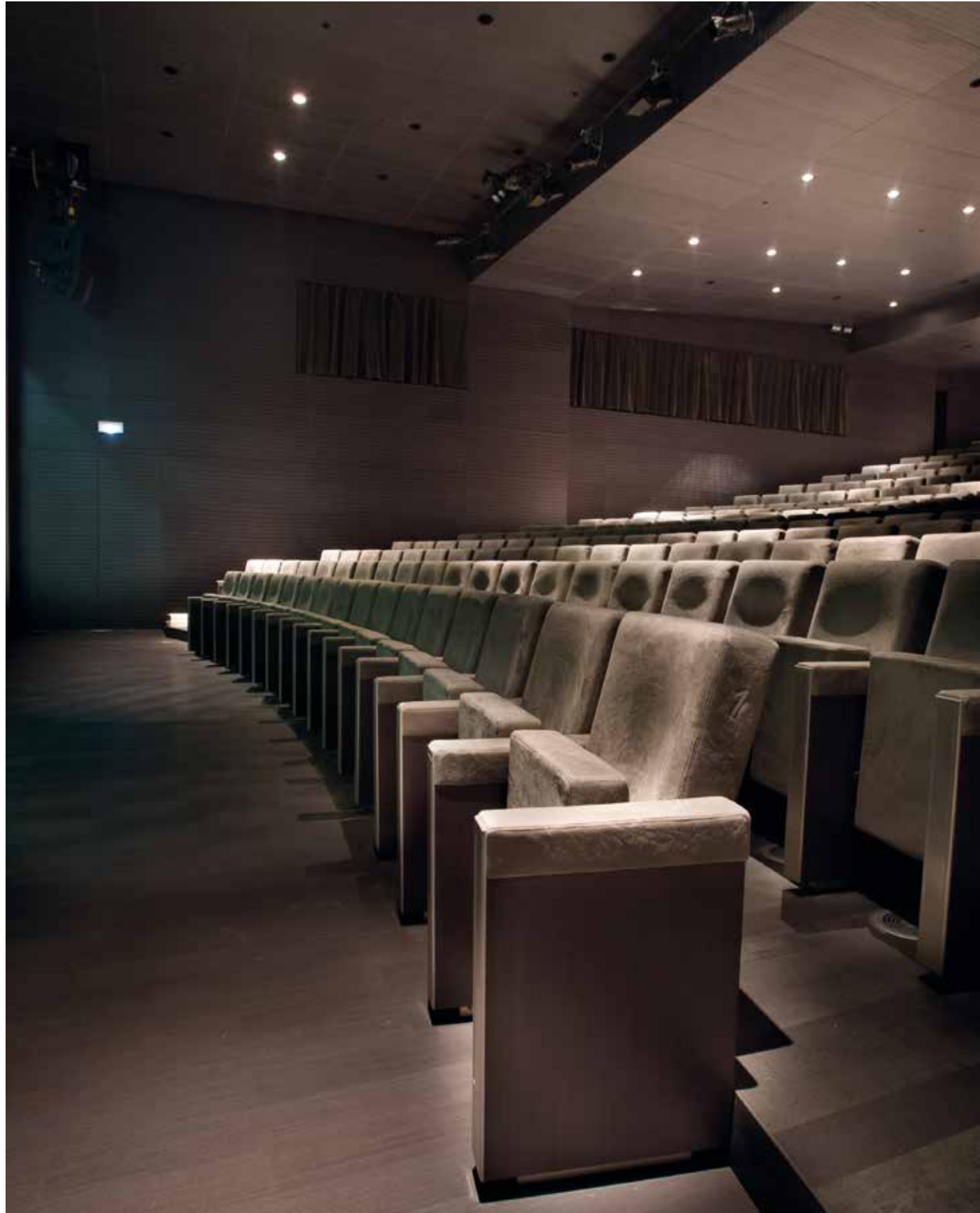

Why not using an auditorium as a conference center?

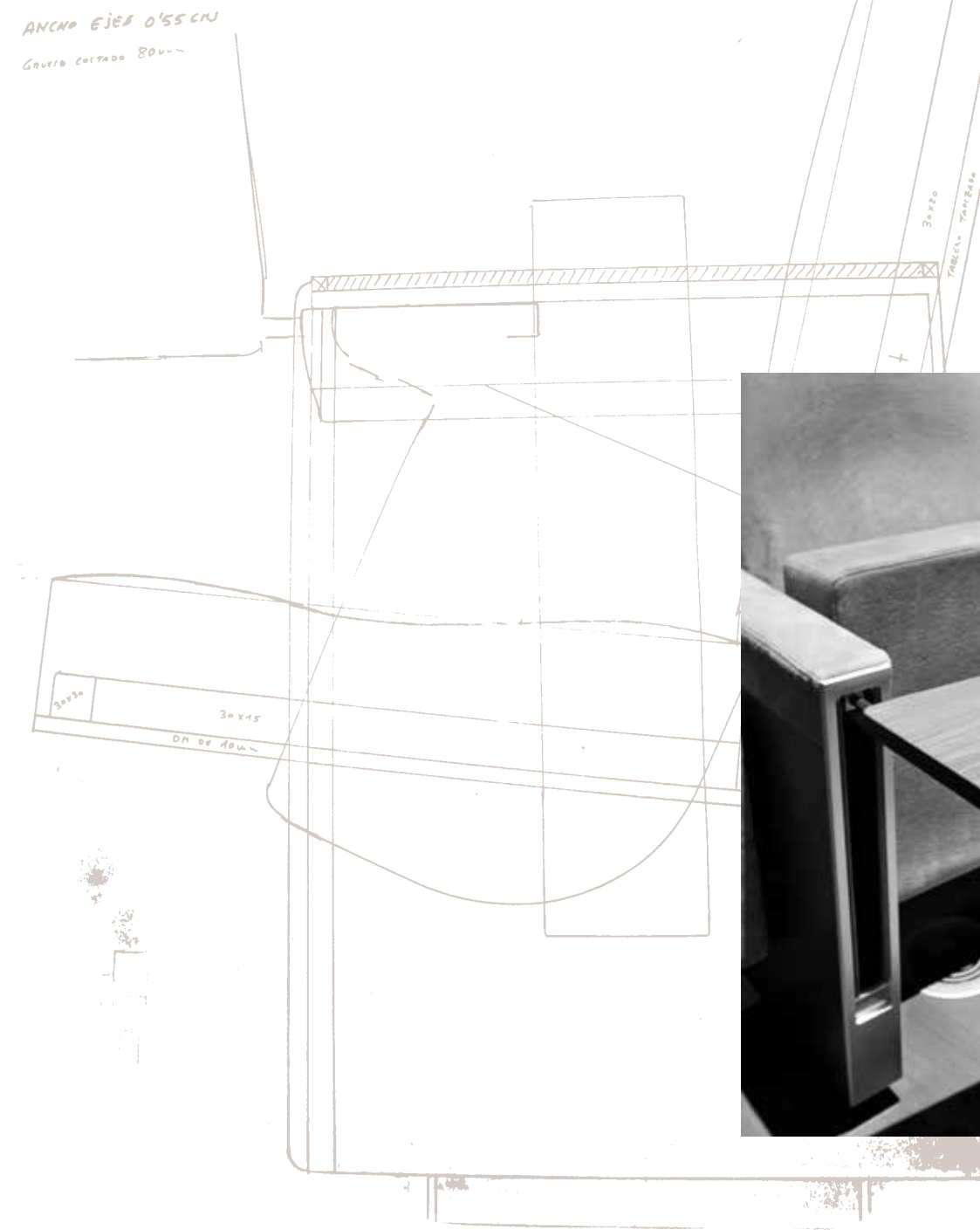



Writing accessories



Customized desks

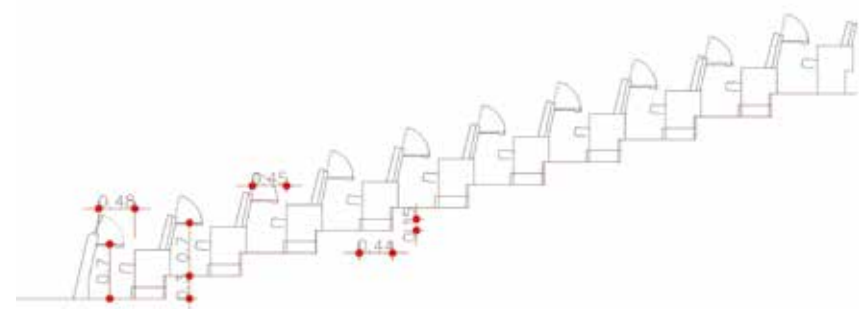

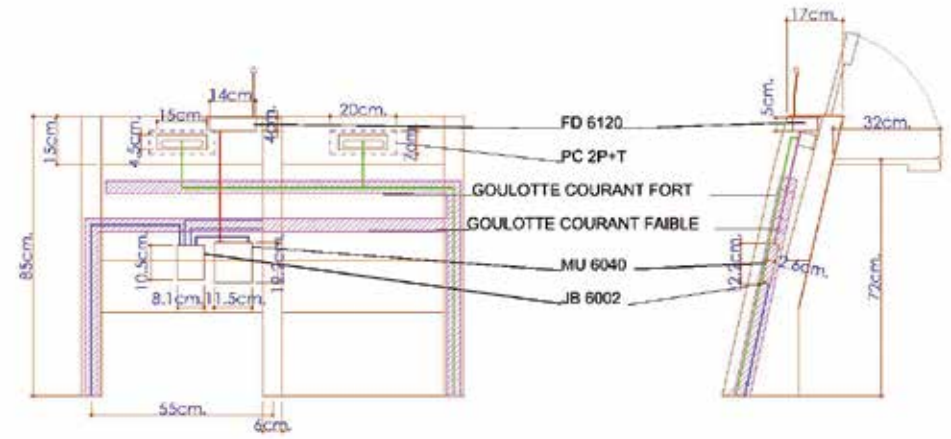

Microphone and communication systems





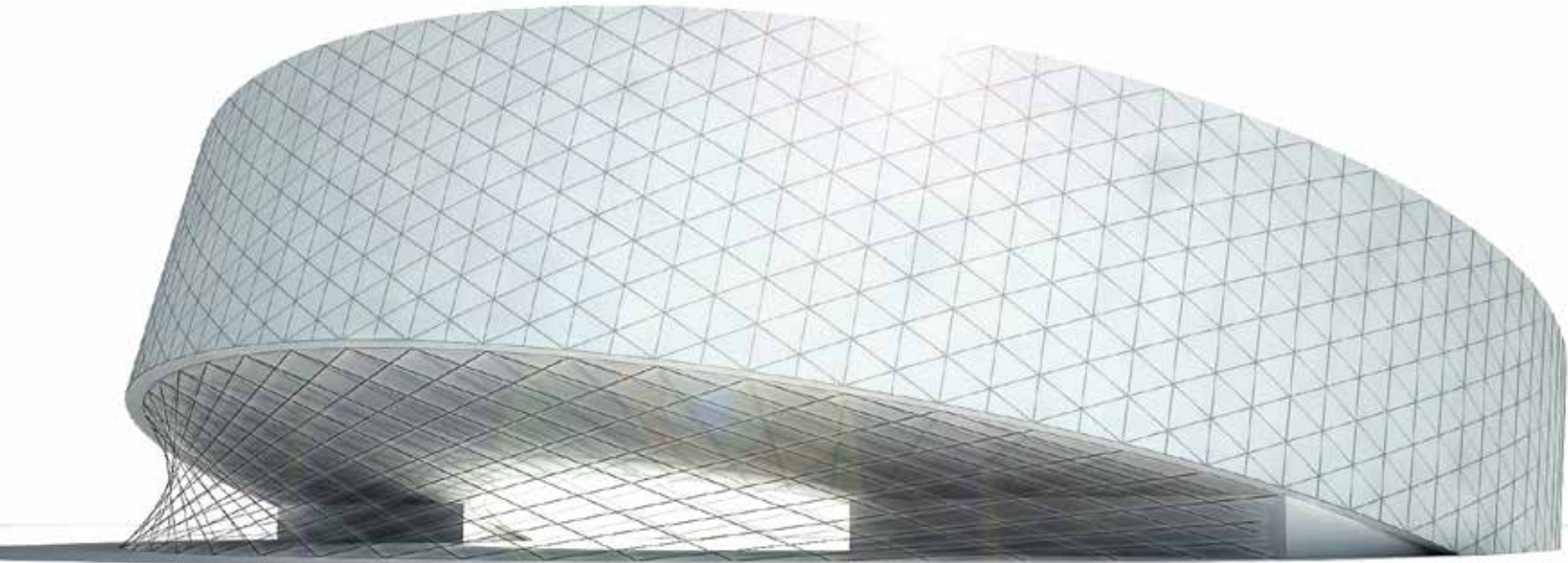



Video & conference equipment

National Parliament of Lithuania

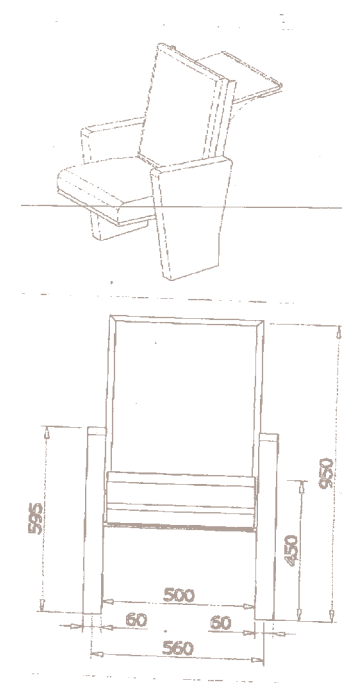





Anodised aluminium cupholders

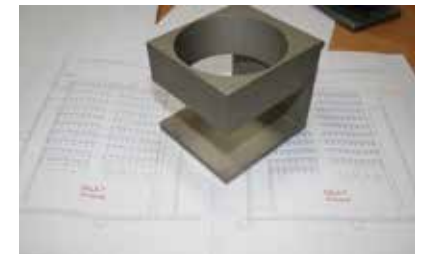
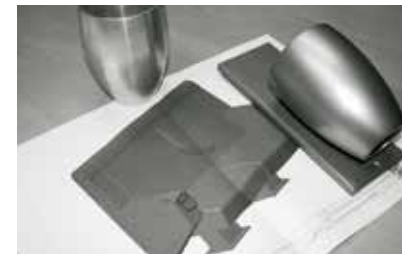



Air vent pedestals



Rotating chairs facing the stage all the time
Y si las butacas pudiesen girar para orientarse hacia el ponente?





Strapontins

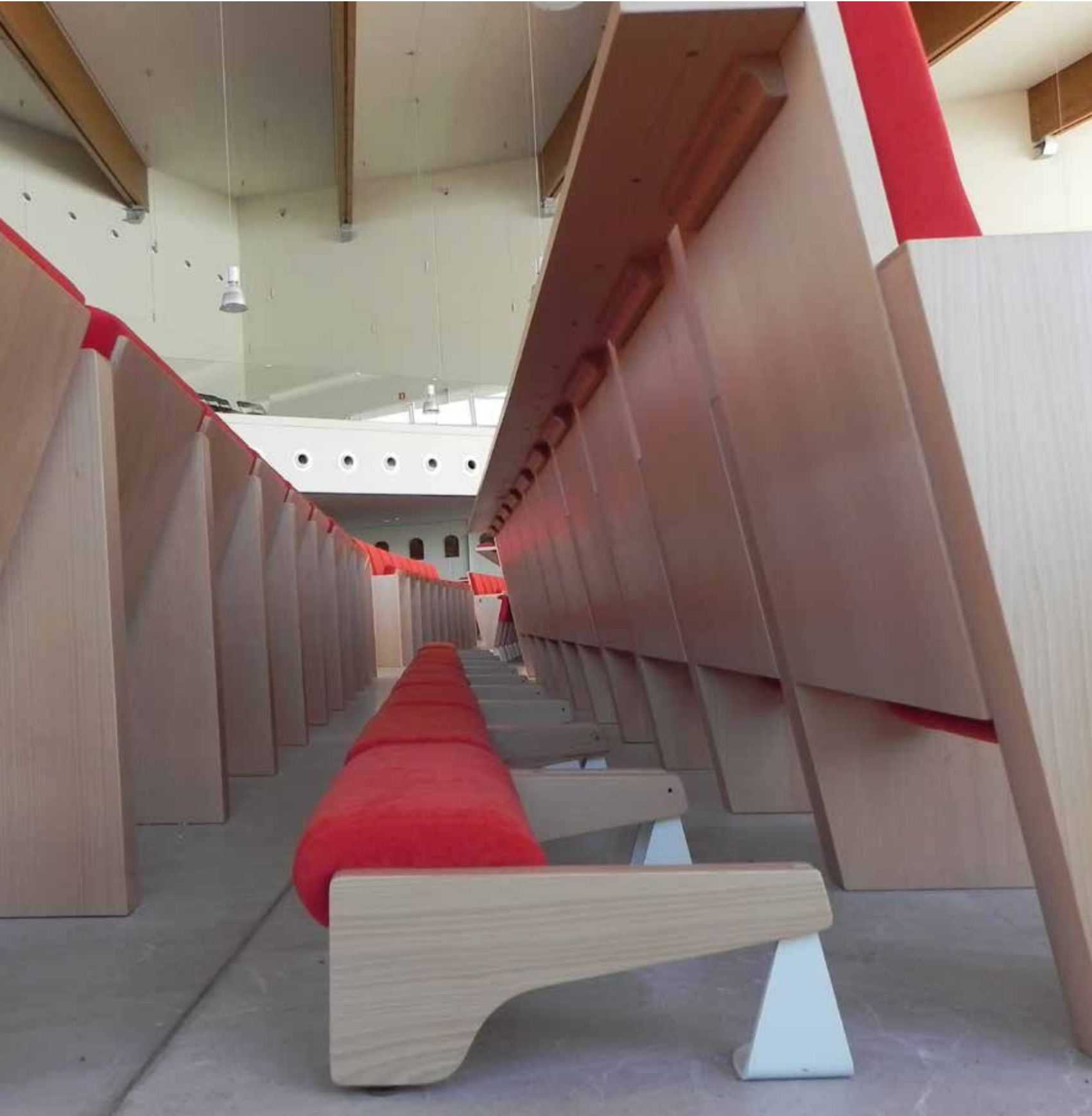

Places of worship







MULTIPURPOSE
The future now

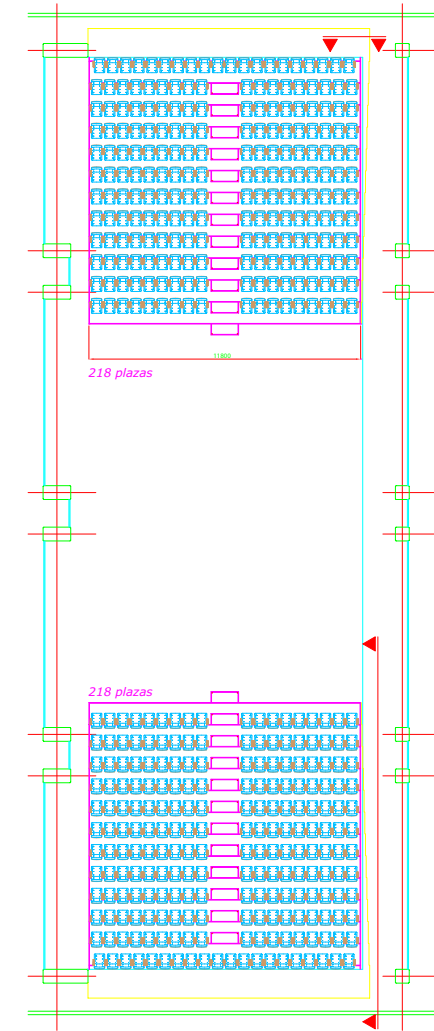

Gradins télescopiques

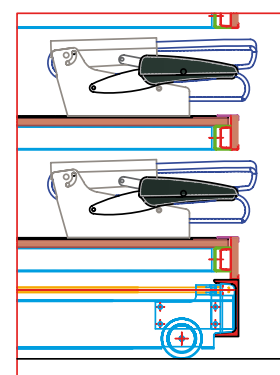
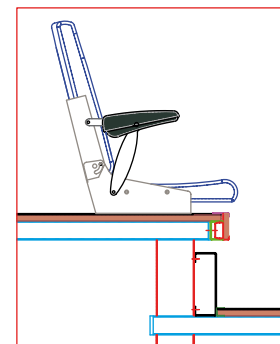
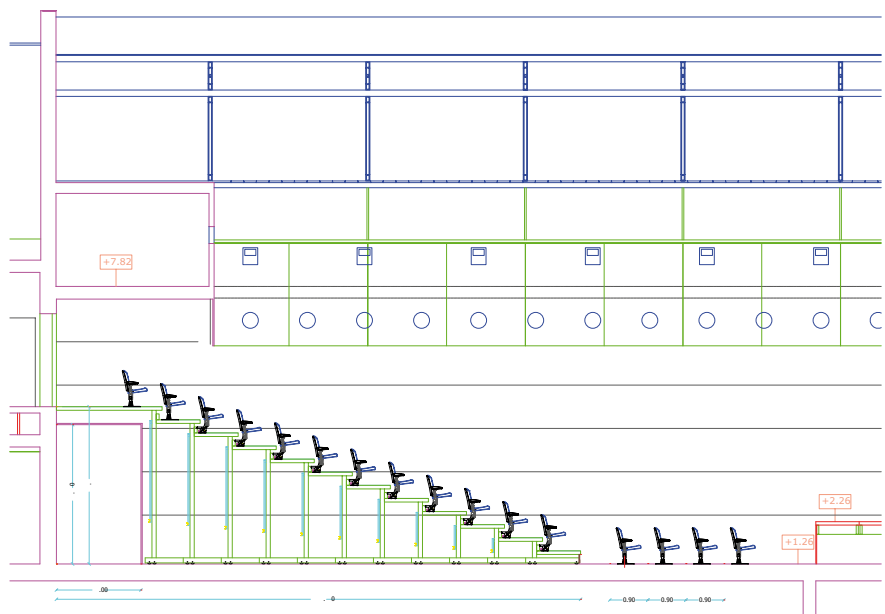



Black Box Theatre
by Jean Nouvel







Fully automatic grandstands

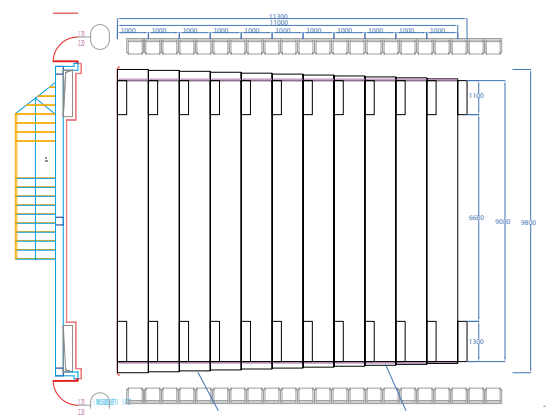
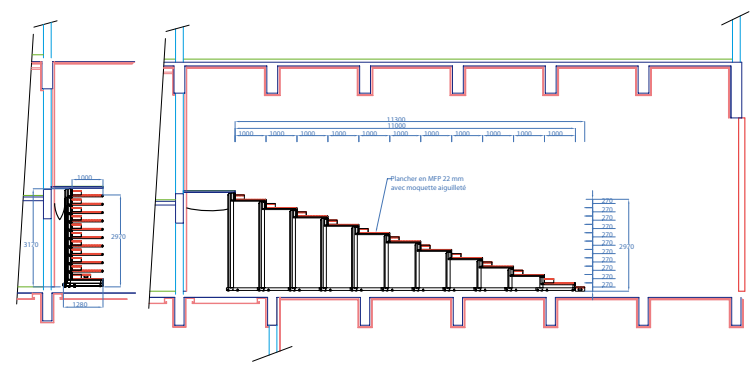



Movable units





Compromise with the finishes





Railing systems

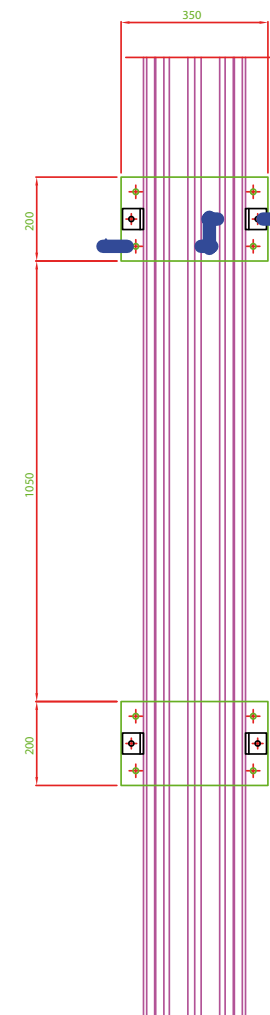
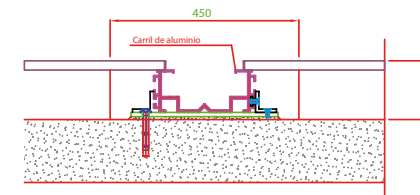

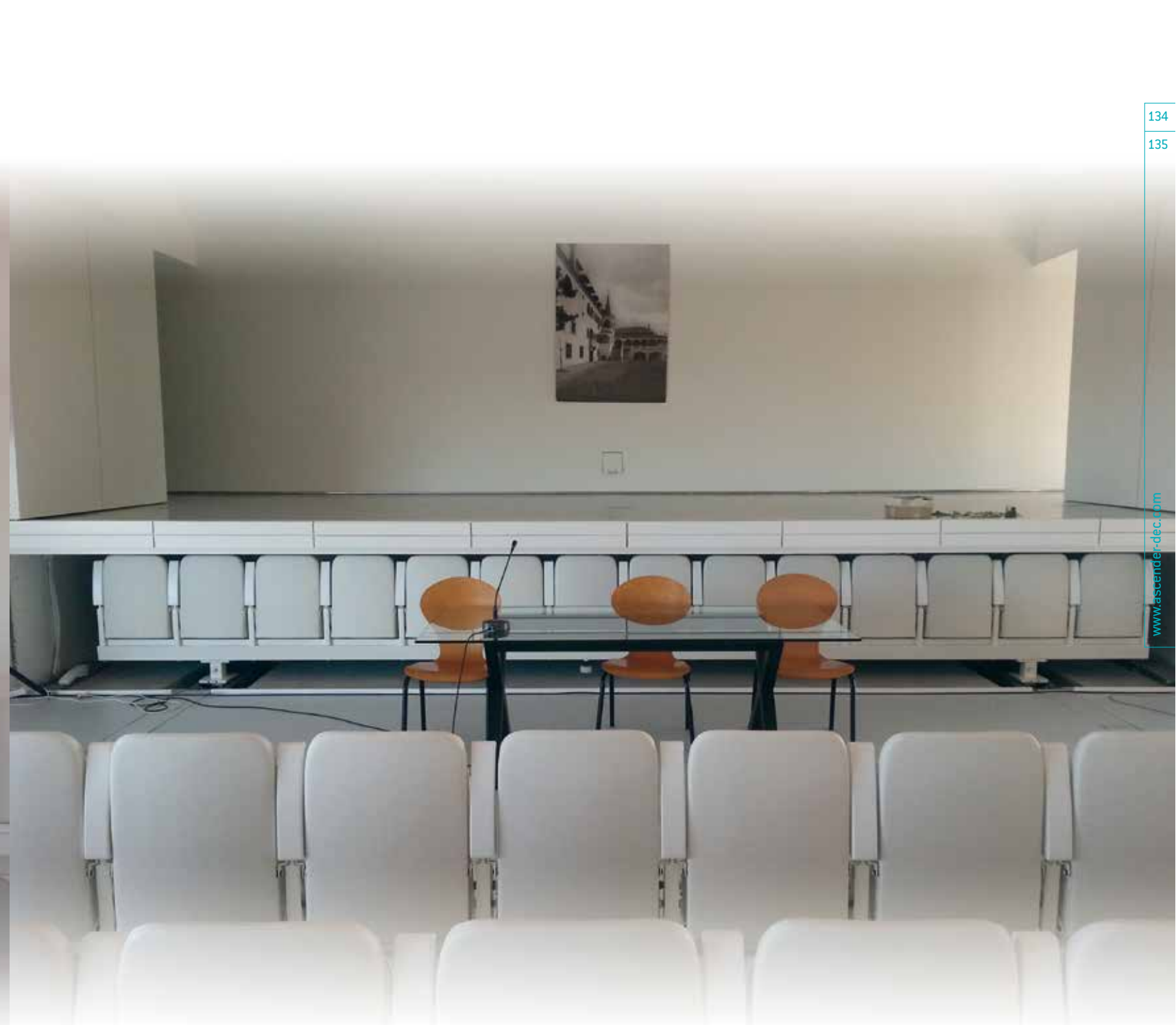

Rentabilidad = ↗ Δ ↔ Δ ↖ = Polivalencia

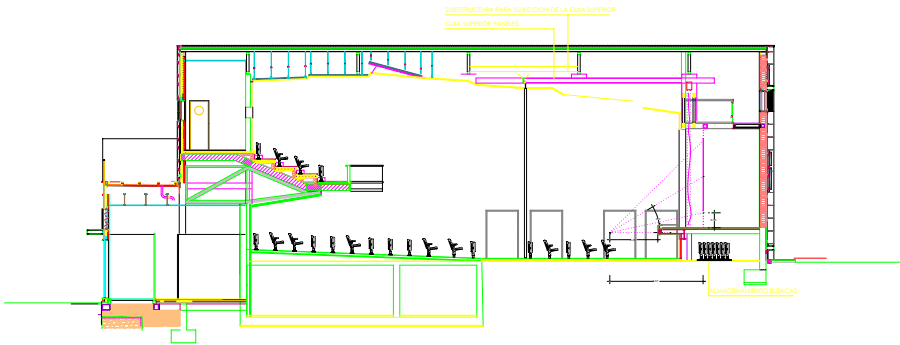

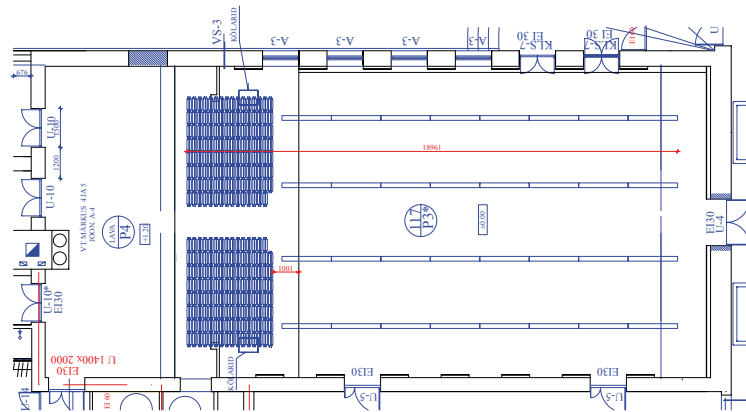



Kangoo

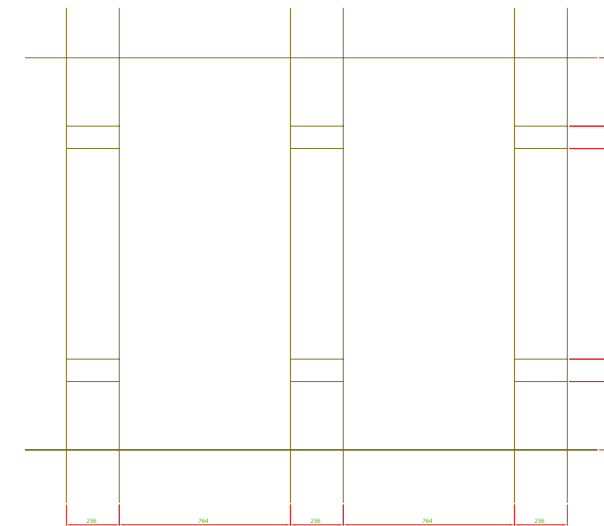
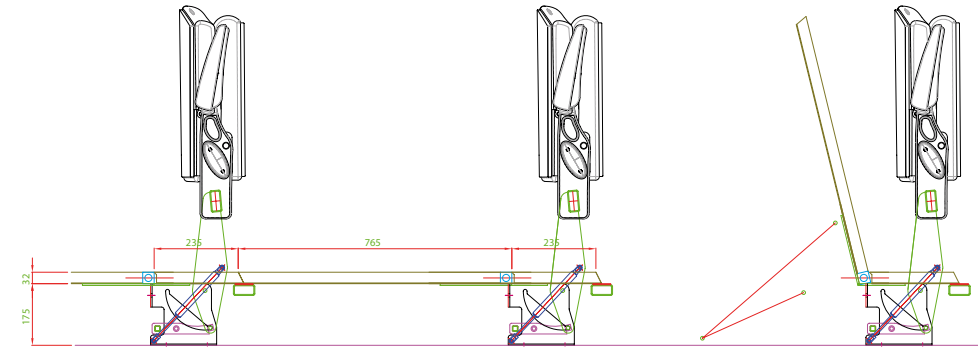



CREDITS

PRINCIPLES

- 10/11 Centro cultural Agora, **SPAIN**
Rojo Fernandez Shaw Arquitectos
- 12/13 La Alhondiga centro de ocio y cultura, **SPAIN**
Atelier Philippe Starck Paris
- 14/15 Agence ITER, **FRANCE** A. *Rudy Ricciotti*
- 16/17 Centre Instruction Navale St. Mandrier, **FRANCE**
A. J.P Mathieu
- 18/19 Teatro Victoria Eugenia, **SPAIN** *Zubiria Arquitectos*
- 20/21 Salon de actos Hospital de Cruces, **SPAIN**
- 22/23 Moscow House of Music, **RUSSIA**
V.Krasilnikov & Y. Gnedovsky
- 24/25 Casa cultura Ermua Antzokia, **SPAIN**
MaaB arquitectura y urbanismo, S.L
- 26/27 Auditorio de Javier, **SPAIN**
- 30/31 Teatro principal de Tarrasa, **SPAIN**
Dilmé & Fabré Arquitectes
- 32/33 Legal advice auditorium, **KUWAIT**
- 34/35 Théâtre Equilibre, **SWITZERLAND** *Dürig AG*
- 36/37 Biblioteca Blanquerna, **SPAIN**
- 38/39 Univ. Politécnica de Madrid, **SPAIN**
- 42/43 Teatro Real Fábrica de Ezcaray, **SPAIN** *Gaforidis S.L.P*

BEAUTE

- 48/49 Georgia National Stadium, **GEORGIA**
- 50/51 Siège Fédération National de Travaux Publiques, **FRANCE**
CAP Architecture / Laurent Meyer Architectes
- 52/53 Alexandrinskii Theatre, **RUSSIA**
- 56/57 Crédit Lyonnais Villejuif, **FRANCE**
- 58/59 Artis TallinFilm, **ESTONIA**
- 60/61 Centro Cultural Villa de Ingenio, **SPAIN**
- 62/63 Vulcania Salle de spectacles, **FRANCE**
- 64/65 Centro cívico de Orkoyen, **SPAIN**
Taller Básico de Arquitectura (TAB)
- 66/67 Centro de Artes Escénicas de Alcobendas, **SPAIN**
A. Fernando Parrilla
- 68/69 Théâtre des Cordeliers, **FRANCE** *Dominique Perrault*
- 70/71 Swedbank, **LITHUANIA**
- 72/73 Szczecin Philharmonia, **POLAND** *Studio Barozzi Veiga*
- 74/75 Escuela de música de Cox, **SPAIN**
Estudio Taller L Garabato2 Arqteconico S.L
- 76/77 Museo Balenciaga, **SPAIN**

IDEES

- 80/81 IMDEA, **SPAIN** *Estudio Lamela*
- 82/83 Hospital Rey Juan Carlos de Móstoles, **SPAIN**
A. Rafael de la Hoz
- 84/85 Giner de los Ríos, **SPAIN** *Estudio amid.cero9*
- 86/87 Auditorio de la Alhondiga, **SPAIN**
Atelier Philipe Starck Paris
- 88/89 Institute of Chemistry & Mecanics, **RUSSIA**
- 90/91 Centre de Gérontologie CG13, **FRANCE**
Cabinet Isnardon.Redondo.Lacube
- 92/93 Amphy de la Communauté Grand Dax, **FRANCE**
- 94/95 Ministry of Interior, **KUWAIT**
- 96/97 Orona Sede Social, **SPAIN**
- 98/99 Sede social de Vestas, **SPAIN** *A. Rafael de la Hoz*
- 100/101 National Parliament of **LITHUANIA**
- 102/103 Conservatoire de Putteaux, **FRANCE**
Brossy & Associes
- 104/105 Cines la Alhondiga, **SPAIN**
Atelier Philippe Starck Paris
- 108/109 Ecole Normale Israélite Orientale, **FRANCE**
Atelier Georges MAURIOS

MULTIPURPOSE

- 116/119 Centro de Disseny Sitges, **SPAIN** *AIA Salazar – Navarro*
- 120/121 Centro de Convenciones de Port Aventura, **SPAIN**
A. Antonio Díaz Curiel
- 122/123 Théâtre de l´ Archipel, **FRANCE** *Atelier Jean Nouvel*
- 124/125 Civil Aviation HQ, **OMAN**
- 126/127 Poznan Trade Fairs, **POLAND**
- 128/129 Escuela de música La Lira de Tremp, **SPAIN**
A. R.M. Puig
- 130/131 King Saud University Orientation Bldg. **SAUDI ARABIA**
- 134/135 Casa Museu Dos Patudos, **PORTUGAL**
- 136/137 Social Antzokia Basauri, **SPAIN**
MaaB arquitectura y urbanismo, S.L.
- 138/139 Tury Concert Hall, **ESTONIA**
- 140/141 CTT Lisboa, **PORTUGAL**
- 142/143 Schneider Electric HQ, **THE NETHERLANDS**

10 años a la cabeza del pelotón



